



\* Share of Freehold \* One bedroom ground floor flat in the heart of Southchurch close to the seafront, Southend East Train Station and amenities. Boasts off-street parking and a private rear garden, along with versatile living space which is well presented throughout.

- Ground Floor Flat
- Lounge and a Sun Room
- Three Piece Bathroom
- Off-Street Parking for Three Vehicles
- Gas Central Heating
- Large Bay Fronted Bedroom
- Good-Sized Kitchen
- Sizeable Rear Garden
- Double Glazing
- Walking Distance to Southend East Train Station

## Brunswick Road

Southend-on-Sea

**£230,000**

Offers Over



1



1



2



C

# Brunswick Road



Bear Estate Agents are pleased to present this one bedroom ground floor flat in Southchurch. The accommodation is well presented throughout and offers versatile living space which comprises a bay fronted bedroom to the front, a lounge which leads into a sun lounge, a kitchen and three piece bathroom. Externally, there is a sizeable rear garden and off-street parking for three vehicles from the front.

## **One Bedroom Ground Floor Flat**

### **Entrance Hall**

### **Bedroom**

16'7 x 13'2

### **Lounge**

13'11 x 10'4

### **Sun Lounge**

10'1 x 5'9

### **Bathroom**

7'0 x 6'0

### **Kitchen**

10'10 x 8'7

### **Garden**

### **Off-Street Parking**





## Floor Plan

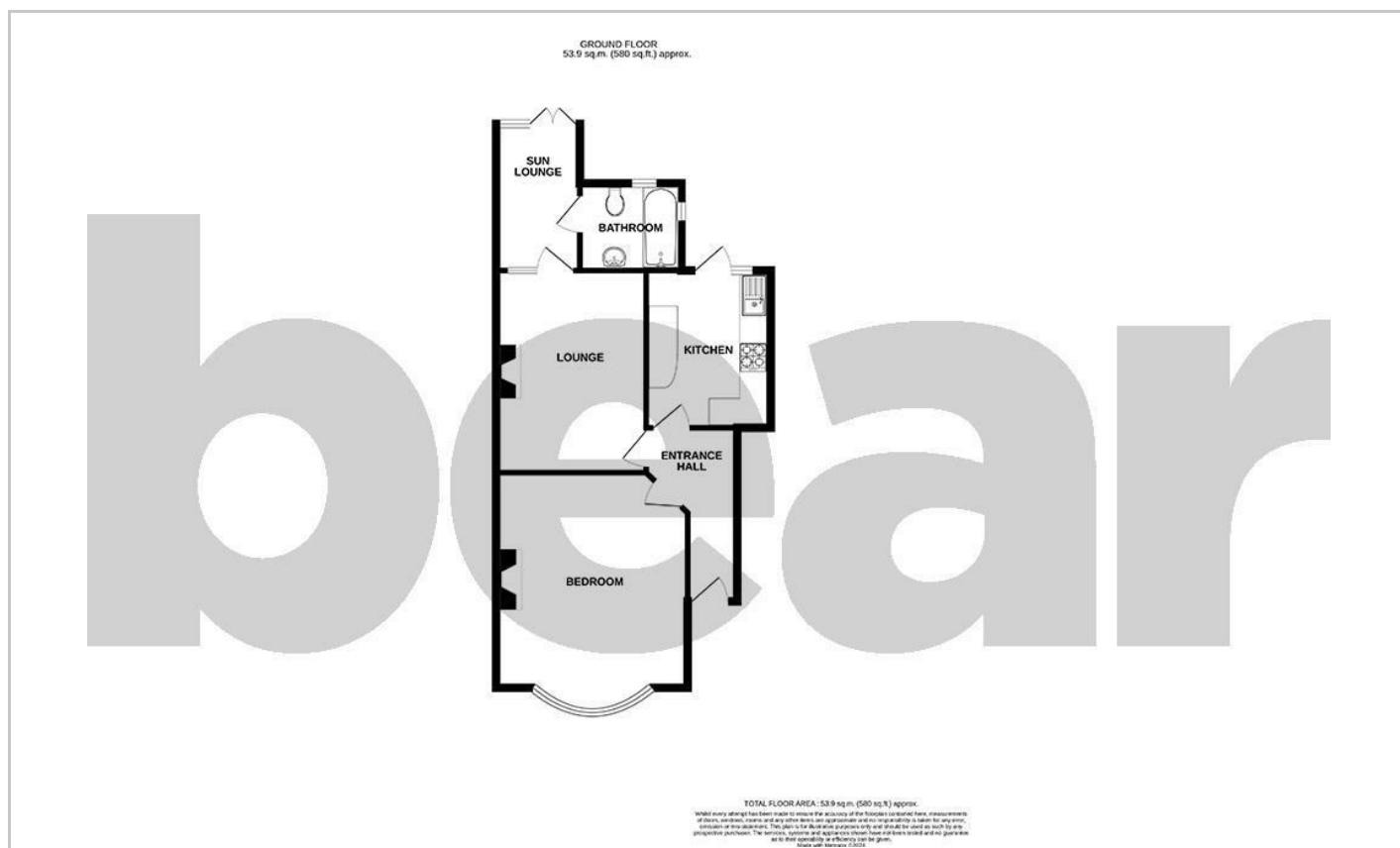

## Area Map

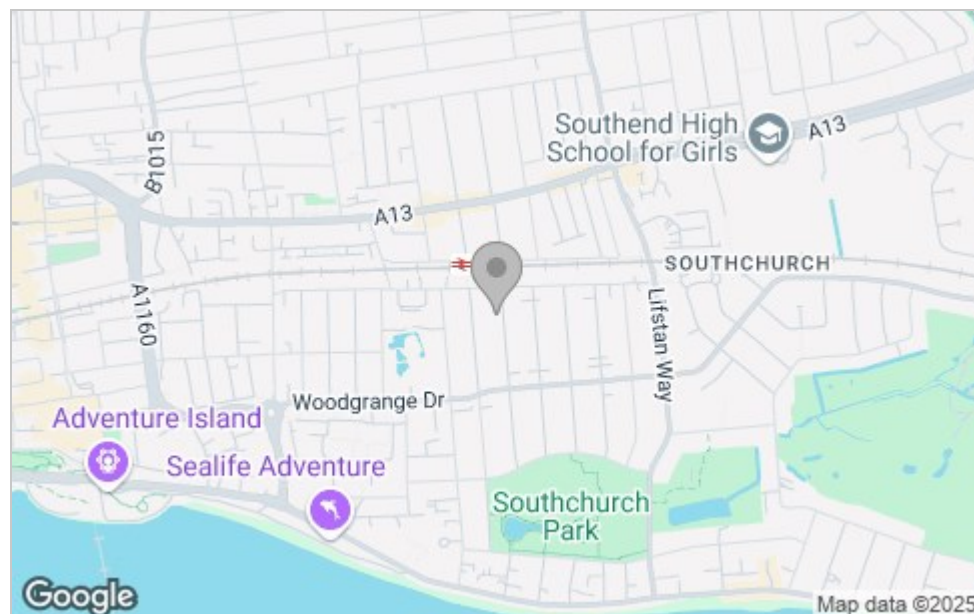

## Viewing

Please contact our Southend-on-Sea Office on 01702 811211 if you wish to arrange a viewing appointment for this property or require further information.

These particulars, whilst believed to be accurate are set out as a general outline only for guidance and do not constitute any part of an offer or contract. Intending purchasers should not rely on them as statements of representation of fact, but must satisfy themselves by inspection or otherwise as to their accuracy. No person in this firm's employment has the authority to make or give any representation or warranty in respect of the property.

204 Woodgrange Drive, Southend-on-Sea, Essex, SS1 2SJ

Office: 01702 811211 [info@bearestateagents.co.uk](mailto:info@bearestateagents.co.uk) <https://www.bearestateagents.co.uk>

### Energy Efficiency Graph

